



# WI-FI DC PUMP

## USER'S MANUAL

### **WARNING:**

- Please use the adapter and related accessories.
- Do not put the pump in the flammable, explosive and corrosive liquid.
- Do not use the pump in the water temperature above 35°C.
- Maximum water depth 1.5M.
- Please refer to the reference table to use this product
- Do not immerse the plug into water or other liquid.
- Do not allow children, or the inexperienced to operate and play with the product alone without safety guarantee.

**Please refer to actual products and APP.**

# Introduction

JEBAO DC pump is a inspected and tested to ensure the safety and operating performance product. Please read this manual carefully, before operating correctly. In case of the improper usage, or maintenance to cause the pump damage.

## Pump Features:

- WI-FI +Manual dual function controller, Smart life
- No electronic device inside of the pump, longer life
- Sine Wave Technology, ultra quiet operation
- LCD screen controller, visual digital
- IC electronic detection,automatic power-off protection upon no water
- Suitable for both marine and fresh water, Rust free

## 1. Products use

① **Used as submersible pump:** the water level should exceed the inlet of the pump to avoid pumping the air. It's ok to add the filter sponge in the mesh/front cover to avoid the suction of sundries and affect the pump performance. The pump conjunction

connector is designed with standard size thread, which can be connected to the common fountain heads and water pipes.

② **Used as dry-use pump:** the pump should be placed lower than the horizontal level to ensure water flowing into the pump. Meanwhile, remove the front filter cover to connect the water pipe with inlet and outlet to ensure water into the pump and pipe before plug on.

## **OPERATING INSTRUCTION:**

When use the pump, please pay attention to the position of the pump. Please connect the pump supply after finishing the installation. If the pump can't pump the water out for the first time which may be caused by the air in the pump body. Please try to plug off and re-plug on to vent the air. To ensure safety, please install a leakage switch with leakage current less than 30mA when using outdoor (the leakage switch shall be installed by the user self).

## **CAUTION:**

- Always disconnect the pump from the power supply before cleaning, maintenance and handling.
- Try to avoid the pump dry working.
- Do not lift the pump by holding the power cord only. In case of the cable connection off inside of the pump
- Do not use the pump in the heating liquid.
- The pump fits for both fresh water and marine water.
- The pump can be used as submersible pump and non-submersible, as long as ensure the pump filled with water
- The pump can't be used in the swimming pool.
- This product has multiple protection function. When it enters the protection state, please plug off and plug on to recover the pump normal work.

## **Controller Features**

- Adjustable the flow rate and head max.
- “Feed” model, Pause, Timing, Delay, Wi-Fi, Restart function.
- Memory function, ensure that the pump rework upon keeping

the same parameter.

### **3, Operation Function:**

#### **1, Controller LCD Display**

After connecting with pump, the control is set per last operation, LCD shows normal locking panel. PXXX is shown in LCD, P is short for power, there are 70 (F30-F100) state for flow rate. When touch “▲ / ▼” button, LCD will show the instant working condition, you can set different power per your need. SP is Speed shortening. More than 1 second no touch the button, the LCD auto change its display on Power “P\*\*\*\*\*” state. Push the “▲ / ▼” button for several seconds to adjust the flow after the controller in lock mode. When touch the “FEED” icon, LCD shows “FdXX” (XX for time), the pump stop work for feeding mode, press the “FEED” icon again, stop feeding, adjust the feeding time in the APP.

**Remarks: When the pump enters to the timer mode set by APP, the LCD will display as P\*\*\*, then keep pressing "▲ ▼" to exit the time.**

## **2, The key Lock Function:**

The pump is under working, press the“FEED button for three seconds until the LED light flashes for 3 times, the controller is locked; Similarly, press the “FEED” button for 3 seconds again, LED indicator light flashes for 3 times, the controller unlocked.

## **3, The LED protection mode:**

Controller is connected with power, more than 17 seconds no touch the control button, the LED will change to the micro bright, the controller enter the screen protect mode; the LCD screen brightness return to normal when press any button.

## **4. Data memory function:**

When power off then re-power on the product, the controller keeping the same default parameter to rework

## **5. Wi-Fi Indication Light and Wi-Fi Button Instruction**

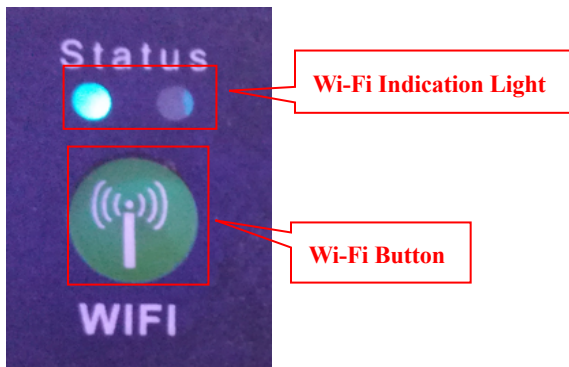

- A. Wi-Fi indication light blinking alternately in green and red while the Pump is on smart configuration mode.
- B. Wi-Fi indication light is flashing simultaneous in green and red while the Pump is on AP configuration mode.
- C. Wi-Fi indication light is in green when the Pump is connected to the cloud server.
- D. Wi-Fi indication light is in Red when the Pump is disconnected to the cloud server.

### **Wi-Fi Button Instruction:**

- A. Press Wi-Fi button for about 5 seconds, the Wi-Fi indication light flashing alternative in green and red. The Pump is into

smart configuration mode.

- B. Press Wi-Fi button for about 10 seconds, the Wi-Fi indication light flashing simultaneous in green and red. The Pump is into AP configuration mode.
- C. The Wi-Fi indication light is in green when connect the WIFI successful.

## **4, APP Download and Instruction**

### **4.1 Download:**

The APP name “Jebao Aqua”, is available to download in App Store for Apple users, or Google Play for Android system users. The User can search “Jebao Aqua” in either App Store or Google Play to download the application. Alternative, the user may scan the barcode on the package or user manual to download the application. (Note: Scan function in certain countries or areas may be unavailable to read the barcode properly.)





iOS Application



Android Application

## 4.2 User registration, login and password reset:

### 1. Account registration:

Enter email address

Enter your password

Log in

Create new account

Forget password ?

Create your account

Enter email address

Create password

Confirm password

Create account

Register by phone number

(Mainland china only)

A> Open Jebao Aqua App and tap *Create new account*.

B> Choose email way to register, fill the information as required and tap Create account;

C> After registration, return back to the login page. enter the

account and password to log in.

**Note:** Phone number registration is valid for mainland China only.

## 2. Reset Password:

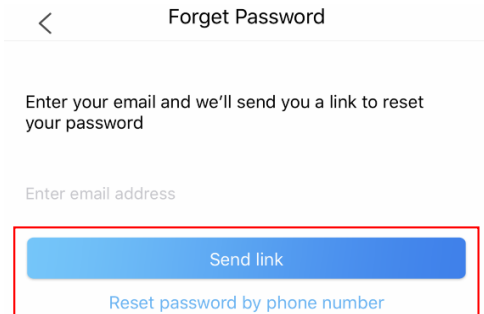

<

Forget Password

Enter your email and we'll send you a link to reset your password

Enter email address

Send link

[Reset password by phone number](#)

Tap *Forget Password* on the log-in page. Enter your email address and tap *Send link*. Check your email and follow the instructions to reset your password. Then back to the log in page to input your account and new password to log in.

## 5, App Application

### 5.1. Main page:

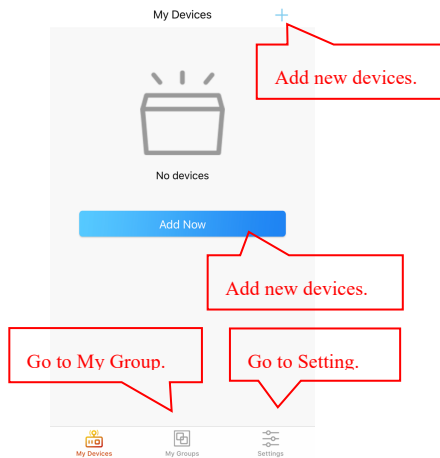

## 5.2 Add new pump:



Tap “Add Now “ or tap the top right “ +” icon to add your device, tap the “Aqua Pump” Icon.

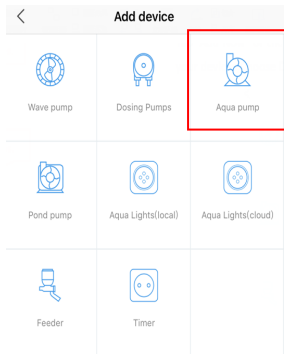

### Configuration mode:

Make sure your phone is connected to 2.4G band Wi-Fi before configuration. There are two configuration modes, Smart configuration and AP configuration modes. Choose one mode to link your device.

① **Smart Configuration mode:** Press the Wi-Fi button for 5 seconds until the Wi-Fi indication light starts blinking alternately in green and red. The Device is in smart configuration mode.

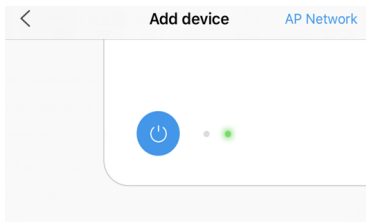

Press the power button for 5 seconds  
Until the red and green lights blinking alternately.

Device is in smart configuration mode

Next

Choose the confirmation” *Device is in smart configuration mode*” then tap “*Next*”, start to smart configuration.



Follow the instructions. Enter Wi-Fi password and tap *Next*.

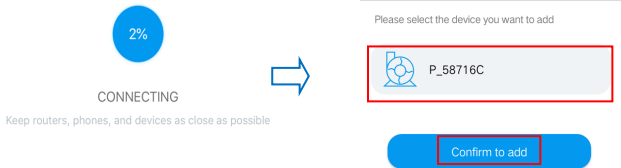

Make sure your device, phone, and router are as close as possible during the configuration progress. The page will display all the devices. Choose the request add device, tap on the device name, then tap ‘*Confirm to add*’

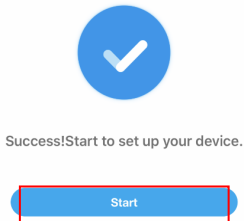

Tap “*Start*” to start using your device.

**② AP Configuration mode:** Press the Wi-Fi button for about 10 seconds until the green and red light blinking simultaneously. The Device enters the AP configuration mode.

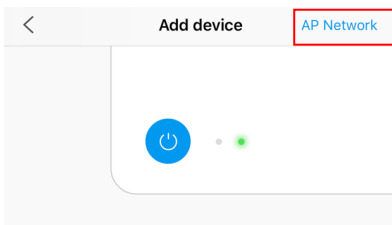

Tap “*AP Network*” in the upper right corner on APP device page to enter into AP configuration.

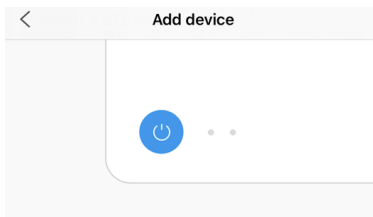

**Press the power button for 10 seconds**  
Until the red and green lights blinking at the same time.

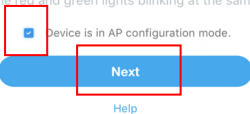

Choos the confirmation “*Device is in AP configuration mode*” and tap “*Next*”

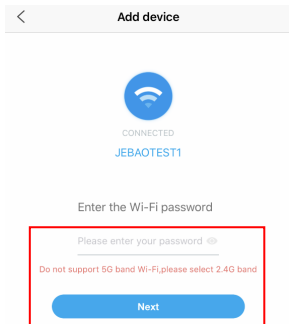

Enter the correct Wi-Fi password and tap “*Next*”

**PS:** Due to different operating system, IOS and Android will operate differently in the following details.

#### **A. IOS System:**

After entering the Wi-Fi password, you need to switch manually the Wi-Fi of the phone to "Jebao\_WiFi-xxxx", the specific operation as below:



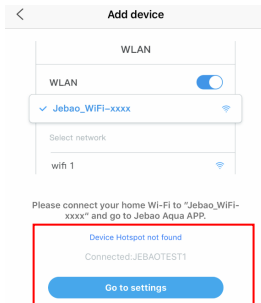

Tap *Go to settings*.

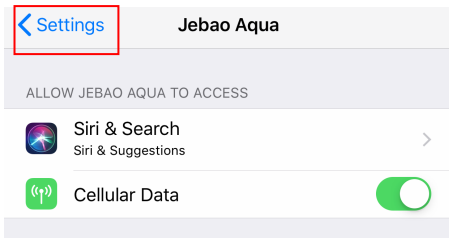

Tap “Settings” in the upper left corner to enter the mobile phone settings page, then enter the WIFI setting page as below.

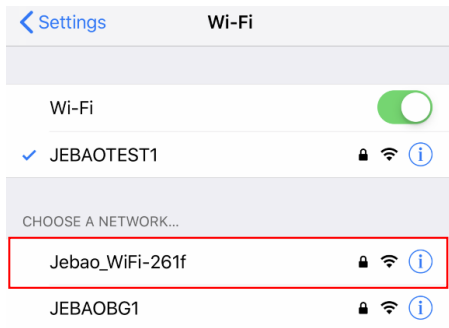

Go to Settings > Wi-Fi and choose the “Jebao\_WiFi-xxxx” with password 123456789. Connecting the Jebao -WiFi

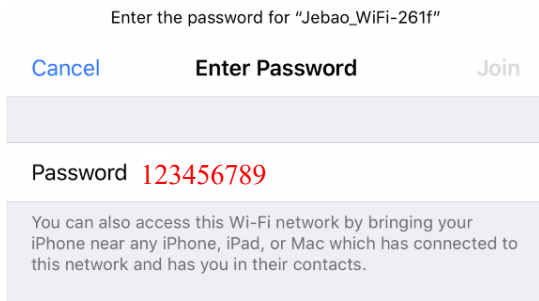

After connection successfully, tap “Jebao Aqua “ return back to the APP.

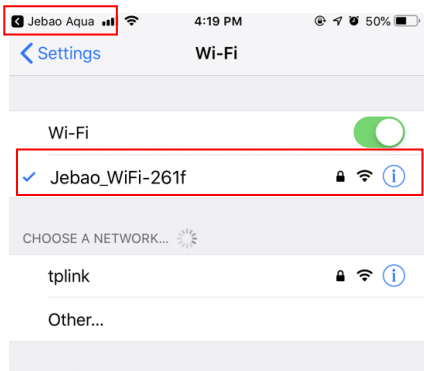

The configuration starts automatically. Tap “*Start*” to control the device after the device has been added successfully.



Success! Start to set up your device.



- B. Android:** After input the Wi-Fi password, tap “*Next*” and choose the device to start configuration. If the device cannot be found, go to Settings>Wireless & networks > WLAN to turn off and turn on the WLAN switch. The device will be displayed.

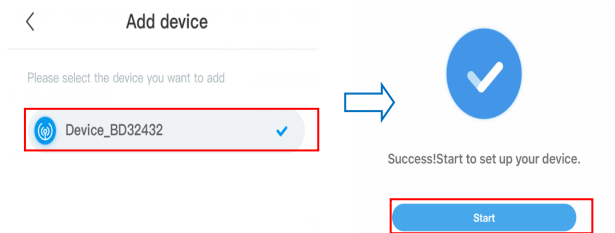

Tap *Start* to control the device after the device has been added successfully.

### Remarks:

1. You may be asked to restart configuration process again if the Wi-Fi password is input incorrect.
2. Try to put the device, mobile phone and router are placed as close as possible.
3. The indicator light keep in Green after connecting the Wi-Fi successfully

## 5.3 Pump control:

After adding the pump device successfully, long press the pump icon for 2 seconds to enter the pump control page.

**Manual mode:** click or drag the arc progress bar (drag to the end then effective), Change the flow value of the pump. The minimum stage is 30 and the maximum is 100.

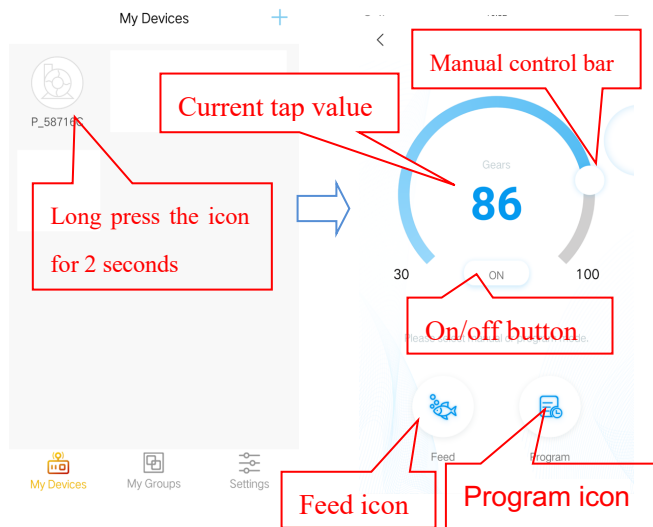

### **Manual feeding mode:**

the pump will stop working immediately according to the setting feeding time. Click the "feed" icon 2 seconds to enter the feeding Settings.

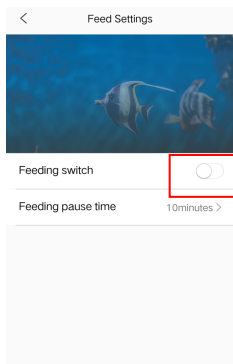
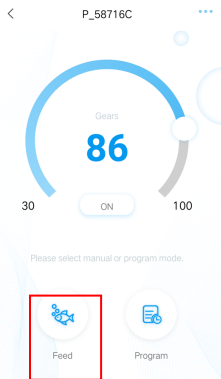

Set the feeding pause time, turn on the feeding switch, then click save and return.

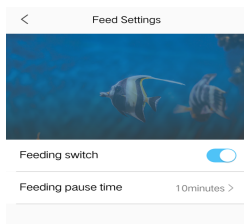
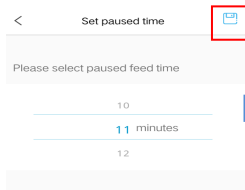

## Program mode :

Long press the "plan" icon 2 seconds to enter the setting page and set the working mode of the pump at various time every day, including the pump stop, automatic and feeding.

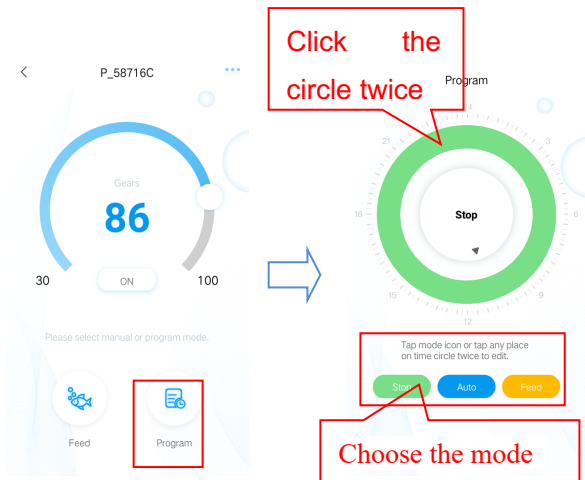

Click the "Stop, Auto, Feed" icon or click the circle twice to edit, each time period.

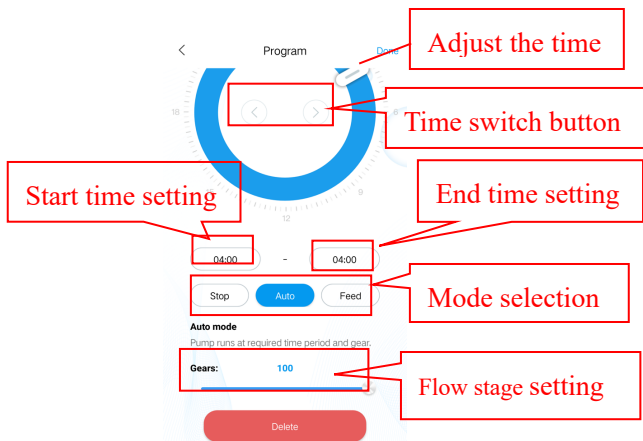

- ① double-click the circle blank area to add the plan time period or use the time switch button to switch to the circle blank area to automatically add the plan time period.
- ② Choose the work mode of the plan time period
- ③ Drag the slider to adjust the start and end time or to modify start and end time directly.
- ④ Click “Done” to save the plan setting.
- ⑤ If want to delete the current setting period, then click delete



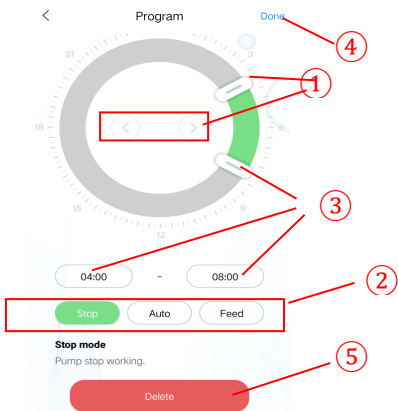

After the setup is completed, return back to the main page and click the “plan” icon to open the plan mode.

**PS:** The plan mode will be closed if you manual to set the flow stage (Plan mode effect after ending the manual mode).

## 5.4 Rename and delete the pump:

The user can change the pump name as want for easy management.

The user can delete the current pump also. But when want to add the pump, need to reconfigure the network and reset the Wi-Fi module if necessary.

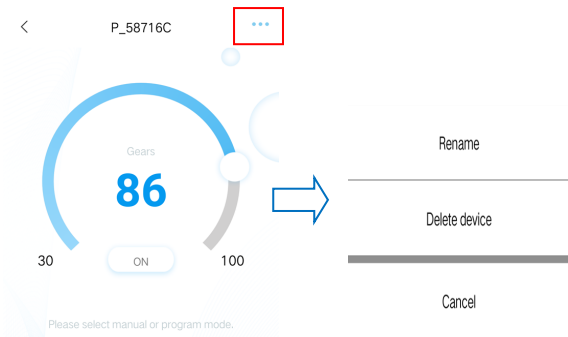

Click the upper right corner of the device as above picture"..." The device can be renamed and deleted.

## 5.5 Failure indicaton:

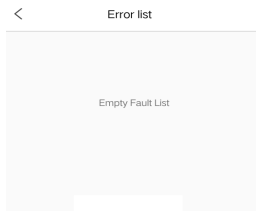
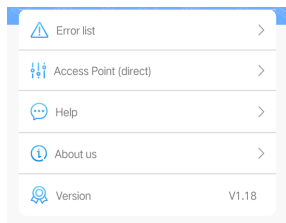

## **LED Error code and APP Error description:**

When the controller work unnormal, the controller will show the Error code and warning flashing, when enter the APP will pop-up the mention box. the code explanation as below:

### **APP mention and error code:**

Controller over current, **Er01:** Abnomal Working current; Check if the pump short of voltage or the controller broken.

Controller over heat, **Er02:** Controller overheating; Check whether the controller exposed to the sunshine or in high temperature environment.

The pump dry running, **Er03:** Pump idling; Check the pump work dry.

The pump was blocked, **Er04:** The impeller stops running, clean the pump and impeller to ensure the impeller is clean and work

Controller overvoltage, **Er05:** Abnomal Working voltage; Check the input supplying voltage.

# MAINTENANCE

If the pump not work, check as following:

- Connect with another power to check if the circuit is connected, disconnect the power before operation;
- Check the pump inlet and outlet, check the connecting pipe for any dirt block;
- Remove the pump inlet to access the impeller. Turn around the rotor to check if broken or jammed.
- Monthly maintenance will prolong your pump life. Clean the rotor, remove the dirt etc.
- The power cord of the pump must be under the power socket to form a drip ring to prevent water into the power socket along the power cord



## **DISPOSAL:**

Please don't dispose this product as unsorted municipal waste. Collection of such waste separately for special treatment is necessary. Not put it together with the domestic waste which should be solved as an authorized place for recycling of electrical and electronic appliances for collecting and recycling waste. Please consult with your local seller, to make sure the product is disposed in an environmental and healthy way.

Jebao Co.,Ltd.

Add: Tongmao Industrial Park, Dongsheng Town, Zhongshan, Guangdong, China.

Tel: +86-760-28136708, 28136720

E-mail: [info@jebao.com](mailto:info@jebao.com)

Website: <http://www.jebao.com>

# Jebao - MDC Pumpen

Bedienungsanleitung

MCD-2000, MDC-3500, MCD-5000,

MDC 6000, MCD 8000, MDC 10000

## **Wichtige Sicherheitshinweise**

**Warnung:** Zum Schutz vor Verletzungen sollten grundlegende Vorsichtsmaßnahmen und folgende Sicherheitshinweise beachtet werden.

- 1) Sicherheitshinweise Lesen und befolgen
- 2) Gefahr: Zur Vermeidung eines elektrischen Schlages sollte die am Aquarium verwendete Pumpe mit Vorsicht gehandhabt werden. In keinem der unten aufgeführten Fälle

sollte eine Reparatur vom Kunden durchgeführt werden. Die Pumpe muss zu einem autorisierten Kundendienst gebracht werden.

a) Wenn an der Pumpe ein abnormaler Wasseraustritt beobachtet wird, muss sie sofort ausgesteckt werden.

b) Nach der Installation sollte die Pumpe sorgfältig überprüft werden. Sie darf nicht eingesteckt werden, wenn sich auf Teilen, die trocken bleiben müssen, Wasser befindet.

c) Eine Pumpe mit beschädigtem Kabel oder Stecker darf nicht in Betrieb genommen werden. Das gleiche gilt, wenn die Pumpe nicht richtig funktioniert, fallen gelassen der anderweitig beschädigt wurde.

d) Um ein Nasswerden des Gerätesteckers oder der Steckdose zu vermeiden, sollten der Aquarium Unterschrank und das Becken seitlich von der Wandsteckdose aufgestellt werden. Somit können keine Tropfen auf den Stecker oder die Steckdose fallen. Eine „Tropfenschleife“ sollte in jedem Kabel zwischen Aquarium und Wandsteckdose vorgesehen werden. Die „Tropfenschleife“ ist der Teil des Kabels, der bei Verwendung eines Verlängerungskabels unter der Steckdose

durchhängt (Bild). Auf diese Weise tropft das Wasser unter der Steckdose vom Kabel ab und kann nicht mit dieser in Berührung kommen. Wenn der Stecker oder die Steckdose nass wird, NICHT das Kabel herausziehen, sondern die Stromversorgung an der Sicherung bzw. am Leistungsschalter trennen. Dann erst den Stecker herausziehen und prüfen, ob sich Wasser in der Steckdose befindet.

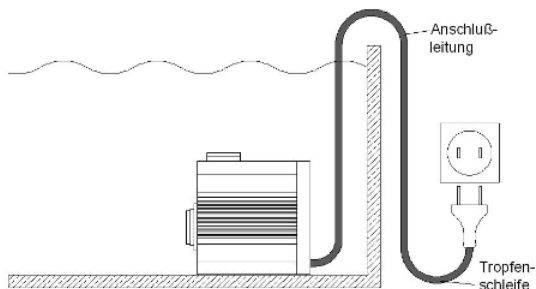

- 3) Kinder müssen beaufsichtigt werden, wenn Sie sich am Aquarium oder in dessen Nähe aufhalten.
- 4) Bei Nichtverwendung, vor dem Montieren/Demontieren von Teilen oder vor dem Reinigen muss die Pumpe stets



ausgesteckt werden. Nicht am Kabel ziehen. Zum Herausziehen des Kabels immer den Stecker greifen.

5) Die Pumpe darf nur für den vorgesehenen Zweck verwendet werden. Die Verwendung von Zubehör, das vom Hersteller nicht empfohlen oder verkauft wird, kann gefährliche Bedingungen verursachen.

6) Die Pumpe nicht an einer Stelle installieren oder lagern, wo sie der Witterung oder Temperaturen unter null Grad ausgesetzt ist.

7) Alle Sicherheitshinweise auf dem Gerät müssen gelesen werden.

8) Wenn ein Verlängerungskabel notwendig ist, muss dieses die erforderliche Leistung haben. Ein Kabel das für weniger Leistung zugelassen ist, kann sich überhitzen. Das Kabel ist so zu verlegen, dass niemand darüber stolpern oder daran hängen bleiben kann.

9) Die Pumpe ist mit einem Schukostecker ausgestattet. Dieser Stecker darf auf keine Weise verändert oder umgangen werden.

**Wird der Stecker entfernt erlischt jeder**

**Garantieanspruch!**

## **Jebao MDC 24V Sinuswellen Pumpen**

Jebao MDC Pumpen sind nach neuesten Erkenntnissen gefertigte elektronisch regelbare Aquariumpumpen mit extrem niedrigem Energieverbrauch.

### **Besondere Merkmale:**

- soft Start
- WiFi Steuerung über das Handy
- Leistungsregelung, 10 Stufen
- 24V Sicherheitsspannung
- Trockenlaufschutz
- Motorschutz bei Blockade
- Futtertimer
- Installation in Süß oder Seewasser

Eingestellt werden können die MDC Pumpen entweder über

Handy oder über den

Controller. Für die Einstellung über ihr Handy benötigen sie die entsprechende App aus dem App Store oder von Google play. Die Anleitung für die App Programmierung liegt von Jebao auf englisch bei.

### **Wichtige Sicherheitshinweise**

Jebao MDC Pumpen werden nach neuesten technischen Standards und

Sicherheitsvorschriften entwickelt und gefertigt. Trotzdem bleibt ein potentielles Restrisiko für Personen und Sachen, wenn die Sicherheitshinweise teilweise oder ganz missachtet werden. Personen unter 16 Jahren und Personen, die unfähig sind, die Sicherheitshinweise zu verstehen und sich danach zu richten, ist die Benutzung der Pumpe(n) aus Sicherheitsgründen untersagt.

Bewahren Sie diese Anleitung an einem sicheren, jederzeit zugänglichem Ort auf!

Bitte lesen Sie diese Anleitung sorgfältig durch bevor Sie mit der Installation beginnen. Sollten Sie trotzdem noch Fragen haben, wenden Sie sich bitte an Ihren Lieferanten oder direkt an Koi Garden Kg.

### **Einbau der Pumpe**

- während der gesamten Installationsphase muss die Pumpe vom Netz getrennt sein.
- nach dem Auspacken die Pumpe, den Controller und die Kabel auf Beschädigungen untersuchen. Sollten Sie Schäden feststellen, darf die Pumpe nicht benutzt werden.
- die Pumpe ist für Installation in Süß- und Seewasseraquarien oder Teichen geeignet.
- die Pumpe ist nicht selbstansaugend und müssen deshalb immer unterhalb des Wasserniveaus installiert werden.
- der Controller muss an einer trockenen, gut belüfteten Stelle, platziert werden.

- die Stellfläche muss eben und fest sein
- niemals kleinere Rohr- oder Schlauchdurchmesser wählen, als von den Pumpenanschlüssen vorgegeben.
- Absperrhähne einen Durchmesser größer wählen und durch Reduzierungen wieder auf das vorgegebene Maß bringen. Der innere Durchmesser der Absperrhähne wirkt wie eine Drossel und kann die Leistung der Pumpe erheblich reduzieren.
- für beste Ergebnisse die Verrohrung immer so kurz wie möglich wählen und mit einer geringen Anzahl von Bögen arbeiten, nach Möglichkeit keine Winkel.
- bei längeren Verrohrungen (über 2 Meter Länge) den Rohr-/Schlauchdurchmesser um eine Nummer größer wählen (32mm -> 40 mm)
- es ist von Vorteil, auf der Saugseite eine gerades Stück Rohr von ca. 300 mm Länge vorzusehen. Dieses bewirkt ein lineares fließendes Wasser

und reduziert Geräusche

- die Pumpe niemals trocken laufen lassen.

- bei laufender Pumpe niemals die Finger in die Saug- oder Druckseite der Pumpe

stecken.

- bei Verwendung von Schläuchen prüfen, ob diese für die Leistung der Pumpe

geeignet sind und keine unerwünschten Stoffe, z.B. Phenole, an das Wasser

abgeben

- bei Verwendung von Rückschlagventilen muss die einwandfreie Funktion

sichergestellt werden, da sonst die Gefahr eines "Trockenlaufs" der Pumpe besteht

- falls gewünscht kann ein Vorfilter mit einer Maschengröße von 2-3 mm an der

Saugseite angebracht werden bei Verwendung von feineren Filter, z.B. Schwämmen,

muss durch regelmäßiges Reinigen die Durchlässigkeit sichergestellt werden,

ansonsten kann es zu Kavitation in der Pumpe kommen

- die Pumpe nicht mit einem teilweisen oder ganz geschlossenen Absperrhahn auf der Saugseite betreiben.

### **Einbau des Controllers**

Der Controller muss an einem trockenen Platz angebracht werden, geschützt vor Sonneneinstrahlung, Beleuchtung und anderen Wärmequellen.

### **Inbetriebnahme der Pumpe**

- stellen Sie sicher, dass die vorhandene Netzspannung mit den Angaben auf dem Pumpentypenschild übereinstimmt
- benutzen Sie für den Betrieb der Pumpe eine Steckdose, die mit einem FI-Schalter (Fehlerstromschutzschalter) 30 mA abgesichert ist.
- Verschrauben sie die Pumpe mit der Verrohrung.
- öffnen Sie die Absperrhähne der Pumpenverrohrung,

sodass die Pumpe mit Wasser  
versorgt wird.

- stecken Sie den Netzstecker des Netzteils in eine geeignete Steckdose

- nach kurzer Zeit erscheinen im Controller Display eine oder mehrere grüne LEDs.

Durch Drücken der + oder – Taste kann die Drehzahl und damit die Leistung  
verändert werden.

### **Überlastsicherung**

Sollte der Pumpenrotor durch einen Fremdkörper blockiert werden, schaltet die Pumpe automatisch ab. Wenn die Ursache der Blockade beseitigt ist, kann die Pumpe neu gestartet werden, oder Sie startet selbsttätig.

### **Stromausfall/Neustart**

Nach einem Stromausfall oder einer Trennung vom Netz, läuft die Pumpe wieder mit der alten Einstellung, mit der sie vor





# Jebao - Pompe MDC

Manuale d'istruzioni

MCD-2000, MDC-3500, MCD-5000,

MDC 6000, MCD 8000, MDC 10000

Importanti istruzioni di sicurezza

**Avvertenza:** Per proteggersi da lesioni, si devono osservare le precauzioni di base e le seguenti istruzioni di sicurezza.

- 1) Leggere e seguire le istruzioni di sicurezza.
- 2) Pericolo: Per evitare la scossa elettrica, la pompa usata nell'acquario o nel laghetto deve essere maneggiata con cura. Il cliente non deve effettuare nessuna riparazione in nessuno dei casi elencati di seguito. La pompa deve essere portata in un centro

di assistenza autorizzato.

a) Se si osserva una perdita d'acqua anomala sulla pompa, questa deve essere immediatamente scollegata.

b) Dopo l'installazione, la pompa deve essere controllata attentamente. Non deve essere collegata se c'è acqua su parti che devono rimanere asciutte.

c) Una pompa con un cavo o una spina danneggiata non deve essere messa in funzione. Lo stesso vale se la pompa non funziona correttamente, è caduta o è stata danneggiata in un altro modo.

d) Bisogna evitare che la spina si bagni. Per evitare che la spina o la presa dell'apparecchio si bagnino, il mobile dell'acquario e la vasca devono essere collocati a lato della presa a muro. Questo evita che le gocce cadano sulla spina o sulla presa. Un "drop loop" dovrebbe essere previsto in ogni cavo tra l'acquario o il laghetto e la presa a muro. Il "drip loop" è la parte del cavo che pende sotto la presa a muro quando si usa una prolunga (foto). In questo modo, l'acqua sotto la presa gocciola dal cavo e non può entrare in contatto con esso. Se la spina o la presa si bagna, NON estrarre il cavo, ma scollegare l'alimentazione dal fusibile o dall'interruttore. Solo allora estraete la spina e controllate se c'è

acqua nella presa.

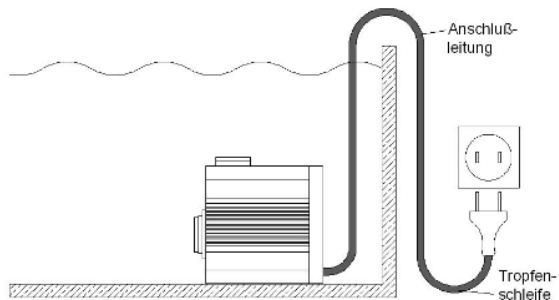

3) I bambini devono essere sorvegliati quando sono all'acquario o nelle sue vicinanze.

4) Scollegare sempre la pompa quando non è in uso, prima di montare/smontare le parti o prima della pulizia. Non tirare il cavo. Afferrare sempre la spina per estrarre il cavo.

5) La pompa deve essere usata solo per lo scopo previsto. L'uso di accessori non raccomandati o venduti dal produttore, può causare condizioni pericolose.

6) Non installare o immagazzinare la pompa dove sarà esposta alle intemperie o a temperature inferiori a zero gradi.

7) Tutte le istruzioni di sicurezza sull'unità devono essere lette.

8) Se è necessaria una prolunga, questa deve essere della stessa potenza. Un cordone di potenza inferiore può surriscaldarsi. Il cavo deve essere posato in modo tale che nessuno possa inciamparci sopra o rimanerci impigliato.

9) La pompa è dotata di una spina con messa a terra. Questa spina non deve essere modificata o bypassata in alcun modo.

**Se la spina viene rimossa, tutti i diritti di garanzia saranno invalidate !**

## **Jebao MDC 24V pompe a onda sinusoidale**

Le pompe Jebao MDC sono pompe per acquari controllabili elettronicamente e prodotte secondo le ultime scoperte con un consumo energetico estremamente basso.

Caratteristiche speciali:

- inizio morbido

- controllo WiFi tramite telefono cellulare
- regolazione della potenza, 10 livelli
- tensione di sicurezza 24V
- protezione contro il funzionamento a secco
- protezione del motore in caso di blocco
- timer di alimentazione
- installazione in acqua dolce o marina

Le pompe MDC possono essere regolate sia tramite telefono cellulare che tramite il controller. Per l'impostazione tramite il tuo cellulare hai bisogno dell'app corrispondente da App Store o da Google play. Le istruzioni per programmare l'applicazione sono fornite da Jebao in inglese.

### **Importanti istruzioni di sicurezza**

Jebao MDC pompe sono progettati e realizzati in conformità con le più recenti tecniche e le norme di sicurezza. Ciononostante, rimane un potenziale rischio residuo per persone e cose se le istruzioni di sicurezza vengono parzialmente o completamente ignorate. Le persone di età inferiore ai 16 anni e le persone che

non sono in grado di comprendere e seguire le istruzioni di sicurezza non possono utilizzare la pompa o le pompe per motivi di sicurezza.

Conservare queste istruzioni in un luogo sicuro e sempre accessibile!

Si prega di leggere attentamente questo manuale prima di iniziare l'installazione. Se hai ancora domande, contatta il tuo fornitore o Koi Garden Kg direttamente.

## **Installazione della pompa**

- durante tutta la fase di installazione, la pompa deve essere scollegata dalla rete.
- Dopo il disimballaggio, controllare che la pompa, il controller e i cavi non siano danneggiati. Se trovate dei danni, la pompa non deve essere usata.
- la pompa è adatta all'installazione in acquari d'acqua dolce e in acqua marina o in stagni.
- La pompa non è autoadescante e deve quindi essere sempre installata sotto il livello dell'acqua.

- il controller deve essere collocato in un luogo asciutto e ben ventilato.
- la superficie di installazione deve essere piana e solida
- non scegliere mai diametri di tubi più piccoli di quelli specificati per le connessioni della pompa.
- Selezionare i rubinetti di un diametro più grande e ridurli alla dimensione specificata. Il diametro interno dei rubinetti agisce come una valvola a farfalla e può ridurre considerevolmente le prestazioni della pompa.
- Per ottenere i migliori risultati, mantenete sempre le tubazioni più corte possibile e usate un numero ridotto di curve, se possibile senza gomiti.
- Per le tubazioni più lunghe (oltre 2 metri di lunghezza), scegliere un tubo/tubo di diametro maggiore (32 mm) o una taglia in più (32 mm -> 40 mm).
- È vantaggioso fornire un pezzo di tubo diritto lungo circa 300 mm sul lato di aspirazione. Questo assicura un flusso d'acqua lineare e riduce il rumore.
- Non lasciare mai la pompa a secco.



- Non mettere mai le dita nel lato di aspirazione o di pressione della pompa quando è in funzione.
- Se si utilizzano tubi flessibili, controllare che siano adatti alle prestazioni della pompa e non rilasciano sostanze indesiderate, ad esempio fenoli, nell'acqua.
- Se si usano valvole di non ritorno, assicurarsi che funzionino correttamente, altrimenti c'è il rischio che la pompa "vada a secco".
- Se lo si desidera, è possibile installare un prefiltro con una maglia di 2-3 mm sul lato di aspirazione. Se si usano filtri più fini, per esempio le spugne, si può montare un prefiltro con una maglia di 2-3 mm sul lato di aspirazione, la permeabilità deve essere garantita da una pulizia regolare, altrimenti potrebbe verificarsi la cavitazione nella pompa.
- Non far funzionare la pompa con un rubinetto parzialmente o completamente chiuso sul lato di aspirazione.

## **Installazione del controller**

Il regolatore deve essere installato in un luogo asciutto, protetto da luce solare, illuminazione e altre fonti di calore.

## **Messa in funzione della pompa**

- assicurarsi che la tensione di rete disponibile corrisponda a quella indicata sulla targhetta del tipo di pompa
- utilizzare una presa di corrente dotata di un interruttore differenziale (RCD) per far funzionare la pompa.
- interruttore (interruttore di corrente residua) 30 mA.
- avvitare la pompa alle tubazioni.
- aprire i rubinetti delle tubazioni della pompa in modo che la pompa sia alimentata con acqua.
- Inserire la spina di rete dell'alimentatore in una presa adatta.
- dopo poco tempo, uno o più LED verdi appaiono sul display della centralina. Premere il tasto + o - per cambiare la velocità e quindi la potenza.

## **Protezione da sovraccarico**

Se il rotore della pompa è bloccato da un oggetto estraneo, la pompa si spegne automaticamente. Quando la causa del blocco è stata rimossa, la pompa può essere riavviata, oppure si avvierà automaticamente.

## **Mancanza di corrente/riavvio**

Dopo un'interruzione di corrente o una disconnessione dalla rete, la pompa funziona di nuovo con la vecchia impostazione con cui era impostata prima dell'interruzione di corrente/disconnessione dalla rete.

## **Manutenzione**

Le pompe Jecod DCP non richiedono alcuna manutenzione speciale o complessa, ma il rotore dovrebbe essere ispezionato a intervalli regolari per la contaminazione o i depositi di calcare. Si raccomanda, specialmente se usato in acqua di mare, di pulire il rotore con un decalcificante commerciale o con aceto.